



PARAMOUNT UNIFIED SCHOOL DISTRICT

GREAT THINGS ARE HAPPENING IN PARAMOUNT SCHOOLS



SUMMER SCHOOL REVIEW AND SCHOOL REOPENING INFORMATION Board of Education Study Session

Mr. Ruben Frutos, Interim Superintendent
Dr. Ryan Smith, Asst. Supt., Educational Services
Dr. Myrna Morales, Asst. Supt., Human Resources

May 17, 2021

District Workgroups and Consultation Teams

SUMMER SCHOOL PLANNING WORKGROUP

- Debra Bolds – Curriculum Specialist, ELA, ELD, and History/Social Science
- Kim Cacpal – Curriculum Specialist, Science and EL Support
- Rita Cruz – Director, Early Childhood Education
- David Daley – Program Administrator, Special Education
- Maggie Flores – Curriculum Specialist, Science
- Greg Francois – Director, Secondary Educational Services
- Leo Gonzalez – Curriculum Specialist, Mathematics
- Marya Hughes – Curriculum Specialist, Mathematics
- Gina Kasper – Program Administrator, Special Education
- Cecile Kim – Curriculum Specialist, Career Technical Education
- Christy Marquez – Curriculum Specialist, ELA, ELD, and History/Social Science
- Joy Go-Ng – Curriculum Specialist, Instructional Technology
- Durrell Jackson – Coordinator, Instructional Technology
- Renee Jeffery – Director, K-5 School Improvement and Innovative Programs
- Kelly Morales – Facilitator, Curriculum & Professional Development
- Osiris Pardo – Curriculum Specialist, AVID
- Malis Pech – Curriculum Specialist, Math and Science
- Nancy Rivas – Curriculum Specialist, Instructional Technology
- Margarita Rodriguez – Director, Research, Assessment, and Student Information
- Sue Saikaly – Interim Director, Special Education
- Sueng-Hae Seo – Curriculum Specialist, ELD
- Manuel San Miguel – Interim Director, Student Services
- Ryan D. Smith – Assistant Superintendent, Educational Services
- Joyce Taylor – Curriculum Specialist, AVID and VAPA
- LaShonda Toston – Curriculum Specialist, ELA

SAFETY PLANS, PROCEDURES AND RESPONSES

Carrie Hatch	Teacher	Hollydale
Jessica Pizzano	Teacher	Jefferson
Jay Lamb	Teacher	Keppel
Mariza Besina	Teacher	Mokler
Brittany Esnayra	Teacher	Paramount High-Senior
April O'Connor	Teacher (TAP Rep)	Zamboni
Maria Prado	School Administrative Asst.	PHS – West Campus
Blanca Castañeda	School Administrative Asst.	Tanner
JoAnn Garner	Job Developer Specialist (CSEA Rep)	Paramount High-Senior
Lisa Kirk	Assistant Principal	Paramount Park
Karen Sullivan	Principal	Gaines
Margie Domino	Principal	Roosevelt
Sergio Espinoza	Supervisor – Custodians	Maintenance & Operations
Cindy DiPaola	Director, Maintenance & Operations	Maintenance & Operations
Jessie Flores	Director, Safety & Security	Business Services
Scott Law	Director, Facilities & Project Dev.	Business Services
Renée Jeffrey	Director, K-5 School Support	Educational Services
Beatriz Spelker-Levi	Director of Personnel	Human Resources
Myrna Morales	Assistant Superintendent	Human Resources

REGISTRATION AND PROCESS ASSISTANCE

Roxana Bonilla – Administrative Assistant
 Ana Galvan – Executive Assistant
 Judy Guinn – Accounting/Budget Technician
 Alex Maldonado – Textbook and Warehouse
 Krystal Mendez – Senior Office Assistant
 Frank Rocha – Senior Accounting Assistant
 Ana Rodriguez – Executive Assistant

Summer School / School Reopening – Study Session

AGENDA

- Legislature, Governor, Regulations and Vaccines
- Safety Plans, Procedures and Responses
- Summer School Review
- Questions and Next Steps

**Proportion of Racial and Ethnic Groups' ≥ 16 Populations*
Who Have Received At Least 1 Dose of Vaccine
As of May 7, 2021**

Race/Ethnicity	# ≥ 16 With At Least 1 Dose Vaccine	# Residents ≥ 16 In Group	% ≥ 16 With At Least 1 Dose Vaccine
Black/African American	258,747	687,786	38%
Latinx	1,607,735	3,820,286	42%
American Indian/Alaska Native	** 11,739	20,310	58%
White	1,424,954	2,362,512	60%
Asian	835,570	1,236,719	68%
Native Hawaiian /Pacific Islander†	20,811	19,694	106%
Multi-Race†	71,800	--	--
Other†	521,193	--	--
Unknown	139,753	--	--
Total	4,892,302	8,325,496	59%

*all population #s include Long Beach and Pasadena

† Multi-Race and Other not calculated due to inaccurate estimates.

† NHOPI number vaccinated may be an overestimate and percent vaccinated may be inaccurate.



Vaccine Update – Study Session

Children between 12 and 15 years old can now receive the two-dose Pfizer-BioNTech coronavirus vaccine after months of research deemed the shot safe and effective for the age group, federal health officials announced Monday.

The U.S. Food and Drug Administration amended the emergency use authorization already set for the shot — the first COVID-19 vaccine authorized in the U.S. — opening it up to millions of more Americans. Until now, only people ages 16 and older were allowed to get the vaccine.

As with our employee vaccination drive, the school district is partnering with the LA County Department of Public Health and local vaccine providers to vaccinate students and community members. Vaccinations for 12 years and older took place over the weekend.

LA DPH Update on Fall Reopening – Study Session

May 13, 2021 As a Fall Reopening update, the LA DPH indicated that the California Department of Public Health (CDPH) has called a workgroup to discuss what school openings and operations will look like moving forward.

The CDPH had their first meeting with County DPHs this past week. LA County is represented and updates will be provided over the next few weeks – LA DPH indicated that there is optimism, but some information is speculative as factors for August/September are still uncertain.

The LA DPH indicated that they will not provide guidelines too far in advance as the information is evolving fairly fast, but masking appears to be fairly certain, even if distancing is reduced. So busing and other issues will be discussed, and how to balance district needs with mitigation risks.

Federal Mask Use Update – Study Session

MAY 13, 2021 - WASHINGTON (AP) — In a major step toward returning to pre-pandemic life, the Centers for Disease Control and Prevention eased mask-wearing guidance for fully vaccinated people on Thursday, allowing them to stop wearing masks outdoors in crowds and in most indoor settings.

The guidance still calls for wearing masks in crowded indoor settings like buses, planes, hospitals, prisons and homeless shelters, but it will help clear the way for reopening workplaces, schools and other venues — even removing the need for social distancing for those who are fully vaccinated.

Environmental Update – Study Session

Indoor Air Quality – Filtration:

Paramount USD has upgraded district wide filtration to improve the air quality conditions in all district facilities. Additionally, to maintain and improve temperature and filtration, the district procured HEPA filters for all district locations. To view the complete list of district filter locations, please visit: <http://bit.ly/PUSDenvironmental>

Local Environmental Update:

The district continues to work with the South Coast Air Quality Management District (SDAQMD) and other local and state agencies to participate in any initiatives dealing with environmental monitoring, evaluation and remediation.

District Reopening – Study Session



Full-time in-person instruction

16%

of California students*



Hybrid instruction

31%

of California students*

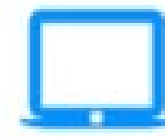

Distance learning only

53%

of California students*

**Based on reports filed by 93.9% of traditional public schools; 87.6% of charter schools; 53.1% of private schools.*

***Hybrid instruction refers to a combination of in-person and distance.*

The California for All Kids Plan

The plan provides a roadmap to equip schools to do this work, specifically by achieving all of the following by 2025-26:

- Universal access to transitional kindergarten so all children enter the school system prepared to succeed
- Year-round access to enrichment activities and before/after-school supplemental education programs for children in low-income communities
- Well-prepared and well-supported teachers
- Deeper connections and relationships between students and adults on campus, with training in tiered systems of student supports, including more school counselors, social workers, and nurses
- Increased access to school-wide nutrition programs
- An improved and more integrated relationship between schools and health care plans, county health, and social services to provide school-based services to children
- Greater student access to broadband internet and computer technology, both in the classroom and at home

Governor – Reopening Schools

The May Revision assumes a return to full-time in-person instruction for the 2021-22 school year. Consistent with all school years prior to 2020-21, this mode of instruction will be the default for all students and schools.

Some parents may still be hesitant to send their children back to school for in-person instruction. To give families a high-quality option for non-classroom based instruction, and to provide local educational agencies with an option to generate state funding by serving students outside the classroom in response to parent requests, the Governor proposes a series of improvements to the state's existing independent study programs.

Safety Plans, Procedures and Responses

Purpose

Review the plans/protocols to be used for students' return to in-person instruction beginning with summer school.

Top Three Mitigation Strategies District will follow

- Wear Masks at all times
- Maintain 6 feet of physical distance
- Wash hands frequently for at least 20 seconds

Based on DPH guidance as of May 11, 2021

COVID-19 COMPLIANCE PLANNING

COVID Compliance Plan

- *Developed by a sub-committee of the Back to School Task Force*
- *Includes District safety protocols for mitigation*
- *Addresses protocols for positive cases*
- *Located on District website*

COVID Prevention Plan

- Addressed Cal-OSHA requirements

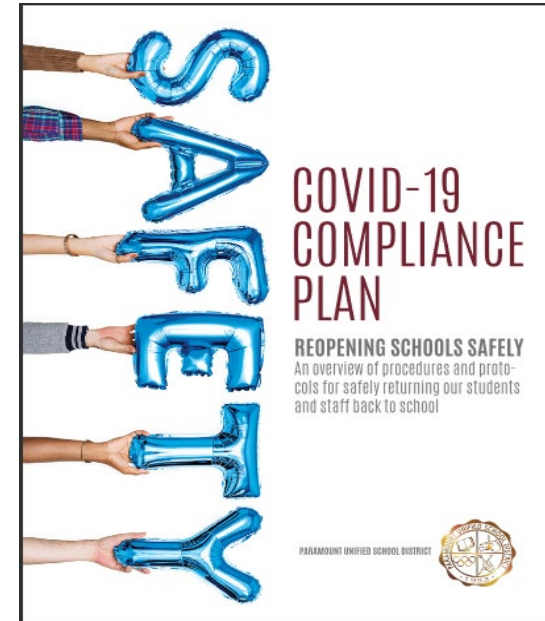

COVID-19 COMPLIANCE

Visitations from Los Angeles Department of Public Health (LADPH)

- LADPH visited and inspected all PUSD school sites during individual testing
- At the time of inspection all sites were found to be in compliance
- PUSD continues to implement the most recent LADPH guidelines and protocols

Transportation

Transportation

Bus riding will be modified.

- All students wear masks
- All students face forward
- Zig-Zag seating format
- 27 riders max

Based on DPH guidance as of May 11, 2021

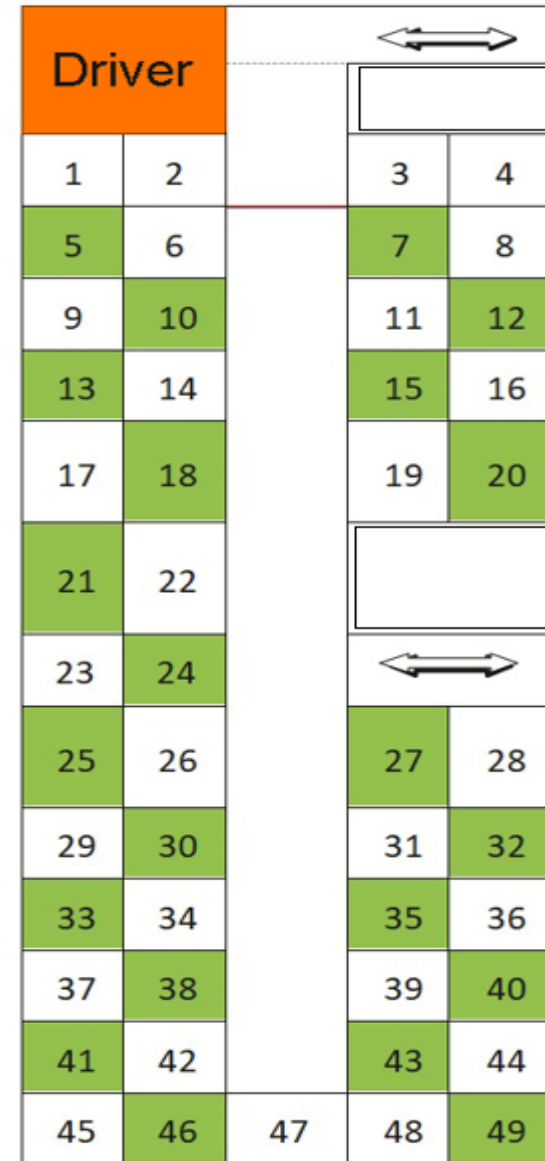

BUS SEATING DIAGRAM

Transportation



- At this time, school bus riders will sit one rider per seat. Seat behind driver is left open for separation and emergency use.
- Student taxi riders will also be seated one rider per seat. There will be no front seat riders.
- For Special Education: Aide may be also sit in the same seat, for safety monitoring of student.
- PPE: All drivers, aides, and students will wear masks. Masks will be available for students, if needed. Sanitizer will be available for students. Sanitizing will be performed at least twice per day.
- Student loading will be completed ‘back to front’ for onboarding and ‘front to back’ for offloading; to minimize touch contacts.
- Air conditioning system will be used and windows will be opened to increase fresh air flow.

Based on DPH guidance as of May 11, 2021

Daily symptoms check

Symptoms Check for students/staff



Step 1

- Check-in daily.
- Answer symptom survey at home. If you answer Yes, to any questions, do not report to school or work.
- Honesty in answering questions is asked for the safety of all staff and students.



STEP 2

Do you have any of the following symptoms

- Fever/chills
- Cough, shortness of breath or difficulty breathing
- Sore Throat, new loss of taste or smell
- Headache or body aches
- Fatigue
- Nausea, diarrhea, or vomiting



STEP 3

- If yes, to any of the symptoms, student/staff members to stay home.
- Nurse will make contact with employee or student.

Based on DPH guidance as of May 11, 2021

DAILY HEALTH CHECK INCLUDE

Paramount Unified School District Safety Procedures

Daily Symptom Check Purpose

All staff and students must check-in daily using the link created to verify that all employees and students at work/school are free of COVID like symptoms.

Staff will receive the link from the District.

Students will receive the link from their school sites that includes the QR code.

Survey are to be answered prior to coming to work or school daily

Daily Check-in Asks

Name

Job Title/Classroom/Grade

Do you have any of the following symptoms (COVID-19 symptoms),

- Fever/chills
- Cough, shortness of breath or difficulty breathing
- Sore Throat, new loss of taste or smell
- Headache or body aches
- Fatigue
- Nausea, diarrhea, or vomiting

Have you had contact with another person who has confirmed or suspected to have COVID-19 in the last 14 days?

Have you been diagnosed or tested to have confirmed or suspected COVID-19 in the last 14 days?

Have you traveled outside of the State of California in the last 10 days? (Fully vaccinated individuals are exempt from the quarantine.)

If yes is answered to any of the above questions, staff and students will be asked to stay home- A District Nurse will contact the employee or student.

Based on guidance as of May 11, 2021

On Campus Adjustments

VERIFICATION OF DAILY CHECK-IN

Staff	Students
<p>Staff:</p> <ul style="list-style-type: none">-Administrative Assistant monitors daily first thing in the morning.-If an employee marks “Yes” for any of the questions, Director of Human Resources is notified to log case and to trigger the response process.-District Nurse will contact employee and determine next steps.	<p>Student:</p> <ul style="list-style-type: none">-Gate greeters will ask if symptoms check has been completed.-School Health Office Technician and support personnel verifies systems check is completed.-Teachers will receive verification of students who have completed symptoms check.-If a student is not on the list, and present in class, teacher will inform the office and student will report to office.

Based on DPH guidance as of May 11, 2021

Safety Preparation: Signage

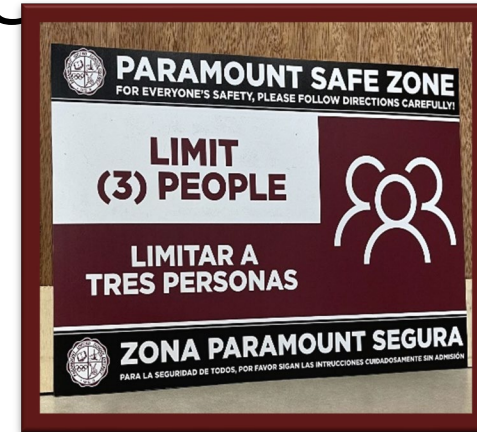
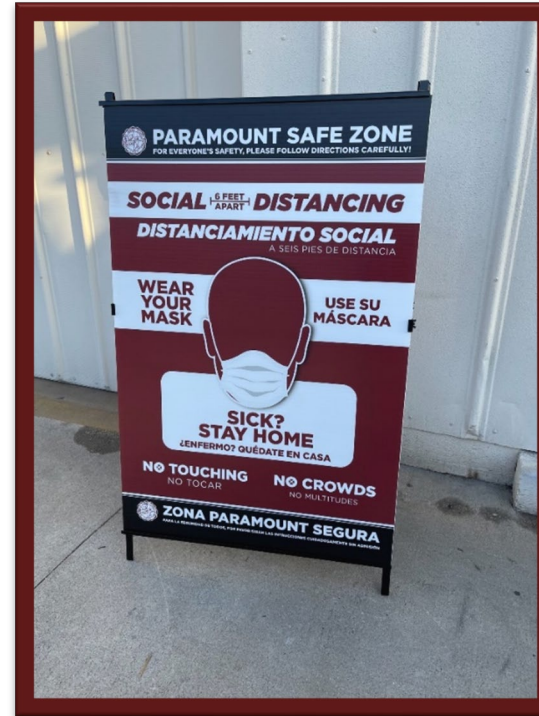

District Safety Signage

- All signage has been ordered and will be at sites by the first week in June.
- General COVID precaution signs will be placed at entrances and high-traffic areas,
- Directional signage such as arrows to mark pathways will be installed just prior to summer school.
- Class by class inspection is ongoing to check for proper signage

Based on DPH guidance as of May 11, 2021

School checklist

Check List for Return to School



Classrooms: Does each classroom where students will be working have...	Notes	Completed
▪ All desks facing forward?		
▪ Area on rug marked for physical distancing		
▪ Limited number of chairs at the horseshoe tables		
▪ Plexiglas for teaching area safely placed or secured		
▪ Individual supplies organized and labeled for each student?		
▪ Extra furniture that will not be used removed or covered?		
▪		

Arrival and Dismissal Procedures Planned for	Notes	Completed
▪ Where school entry points will be?		
▪ Who will staff each entry point?		
▪ Who will monitor students waiting to enter?		
▪ How you will stagger dismissal times?		
▪ Taxi/transportation travel and drop off		
▪ Late pick up procedures		
▪ To assemble an "entry pack" with walkie-talkie, clipboard, COVID symptoms check list, infrared thermometer for each entry team?		

Common Areas Planned for	Notes	Completed
▪ How hallways will be labeled for single direction?		
▪ How bathrooms will be used to minimize the number of students at one time?		
▪		
▪		

Cleaning and Sanitation Planned for	Notes	Completed
▪ Wiping down of desk and table tops?		
▪ Secured enhanced PPE?		
▪ Training for health and safety services?		
▪		

Food Distribution Planned for	Notes	Completed
▪ How will students receive their breakfast?		
▪ How will students get their lunch		
▪ If eating on campus, how will tables where students will eat to allow sufficient seating and spacing?		

Based on guidance as of May 11, 2021

School Site Safety planning visits

District personnel and Site Principals are conducting on-site safety planning reviews.

Each School site is planning for

- Arrival and Dismissal procedures
- Student and staff directional travel on campus
- Classroom configurations
- Eating areas
- Physical distancing practices in all areas
- Signage and PPE
- Sanitation schedules

Based on DPH guidance as of May 11, 2021

Receiving students at the beginning of the day

- Schools will provide multiple entrance points to minimize groupings.
- Once students enter the school, students will be directed to line up either by their home room or a designated area in the quad to enhance social distancing.
- Staff will escort students into the classrooms to minimize contact with others.
- Diagrams of ingress and egress for different classrooms configurations will be made available to sites.
- If spacing indicators are necessary when students return, painted dots will be applied to the "line up" locations.

Based on DPH guidance as of May 11, 2021

Student restrooms

- Support staff will be utilized to monitor restrooms, as needed.
- Restroom occupancy and usage will follow Department of Public Health recommendations at the time
- COVID safety precautions procedures posters/stickers are placed in all restrooms that students will use.
- Student Restrooms will be stocked with soap and sanitizer.
- Sanitizer stands are placed outside of each restroom, so adults may monitor use before and after visiting the restroom.
- Restrooms cleaned and disinfected every two hours
- Restrooms are receiving new touchless hand dryers

Based on DPH guidance as of May 11, 2021

Lunchtime

- Child Nutrition Waivers have been extended through June 2022
- Grab and Go format will continue during summer school.
- Students will not need to use keypads, cafeteria personnel account for number of students that have received a lunch.

Based on DPH guidance as of May 11, 2021

Lunch time protocols

Outside areas utilized for eating.

- Cafeteria seating may be moved outside daily for additional seating.
- Lunchtime safety signage and reminders will be posted.
- Stickers directing students to designated eating areas that are 6 feet apart from each other.
- Eating areas are cleaned after each lunch service.

Based on DPH guidance as of May 11, 2021

Play equipment

- Use of Playground equipment use will be in compliance with current regulations.
- High touch surfaces will be disinfected after each recess period.
- More recess time slots are added to limited the number of students that are out at one time



Based on DPH guidance as of May 11, 2021

Water stations

- Drinking fountains are closed
- All sites have bottle filling stations
 - Minimum of 3 stations at all sites, more at larger campuses
- Individual, reusable water bottles purchased for all students
 - Printed with each school's name and mascot
 - Students will write their names on bottles and use daily

Based on guidance as of May 11, 2021

Water Stations and Water Bottles



Based on DPH guidance as of May 11, 2021

Classroom configuration and set up

- Desks are set up facing in one direction
- Rooms are configured with three feet of spacing in all directions between students
- Plexiglass teaching shield are available
- Safe walkways
 - Maintaining six feet of distance
 - Students enter classrooms and move in a clock-wise route to their assigned desks



Based on guidance as of May 11, 2021

Path of travel inside of the classrooms

One Entrance & Exit Door

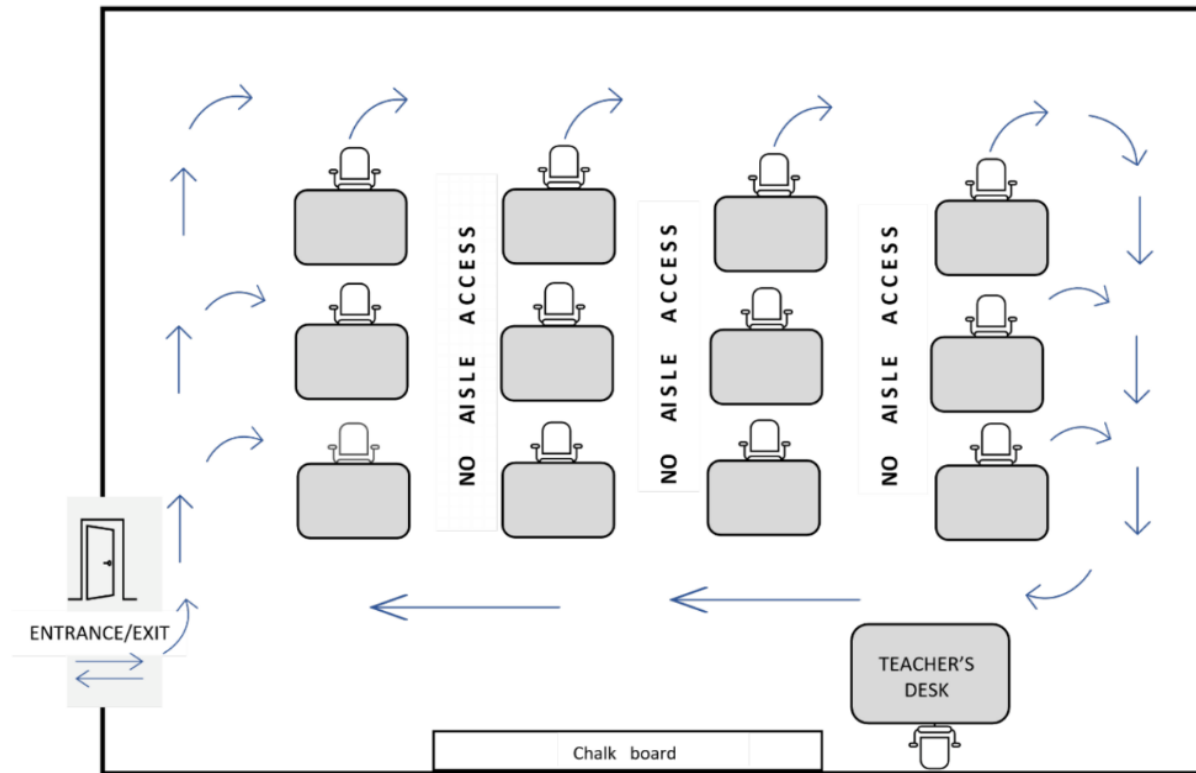

Based on guidance as of May 11, 2021

Classroom

- Personal Protective Equipment provided
- Sanitizer dispensers are in each classroom
- Safety/Cleaning kit in each room



Based on DPH guidance as of May 11, 2021

Cleaning of Facilities

How are cleaning and disinfecting different?

Cleaning	Disinfecting
removes loose soils, preparing the surface or object to be disinfected	kills germs on the surface, preventing them from spreading

All disinfecting agents used by the District are EPA-approved

Based on DPH guidance as of May 11, 2021

Cleaning/Disinfecting Schedules

Intervals

- Daytime
 - All high-touch areas are disinfected every 2 hours unless there are emergencies
 - Doors, restrooms, bottle fillers, common areas, etc.
- Nighttime
 - All occupied rooms and common areas are cleaned (every other night) and disinfected (nightly)
 - Rooms are treated with disinfectant using Victory Electrostatic sprayers
 - The Disinfecting system has a 'staying agent' to hold product on surface for several days

Based on DPH guidance as of May 11, 2021

Campus Cleaning: Disinfectant sprayers



Based on DPH guidance as of May 11, 2021

Cleaning in between classes at middle and high school

- Entering middle and high school students get disinfecting wipes at the door
- Proceed to wipe off desk surface area and chair
- Dispose of wipe
- Sanitize hands



Based on DPH guidance as of May 11, 2021

Music classes/Band

- Instrumental and choral classes/groups will be held outside
- 10 feet distance in between individuals
- Face Shields where appropriate
- Bell covers for Trumpets, trombones, baritones, and tuba.

Response to COVID Symptoms

Health room procedures/individuals with symptoms protocols

Symptoms

If student shows any of the following symptoms:

Cough

Fever & chills

Shortness of breath

Loss of taste or smell

Fatigue

Muscle or body aches,

Headache

Sore throat

Congestion or runny nose

Nausea or vomiting

Diarrhea

Call Health Office

Indicate need for designated quarantine area:

Staff will meet student to escort to quarantine area

Brief evaluation of symptoms while distancing from other students and staff

Call parent and District Nurse

Log parent call and symptoms

Review return date and protocol with parent

Send student home with self-quarantine letter indicating first date student is able to return

Document & Communicate

Update Covid-19 log by 11:00 a.m. daily

Communicate with staff and teachers the first date student can return to class (14 days)

Follow-up to ensure that student does not return to class until quarantine is complete

Nurse will contact parent half-way through quarantine

Ensure students are screened in health office prior to attending class on date of return

Actions for positive case of COVID-19

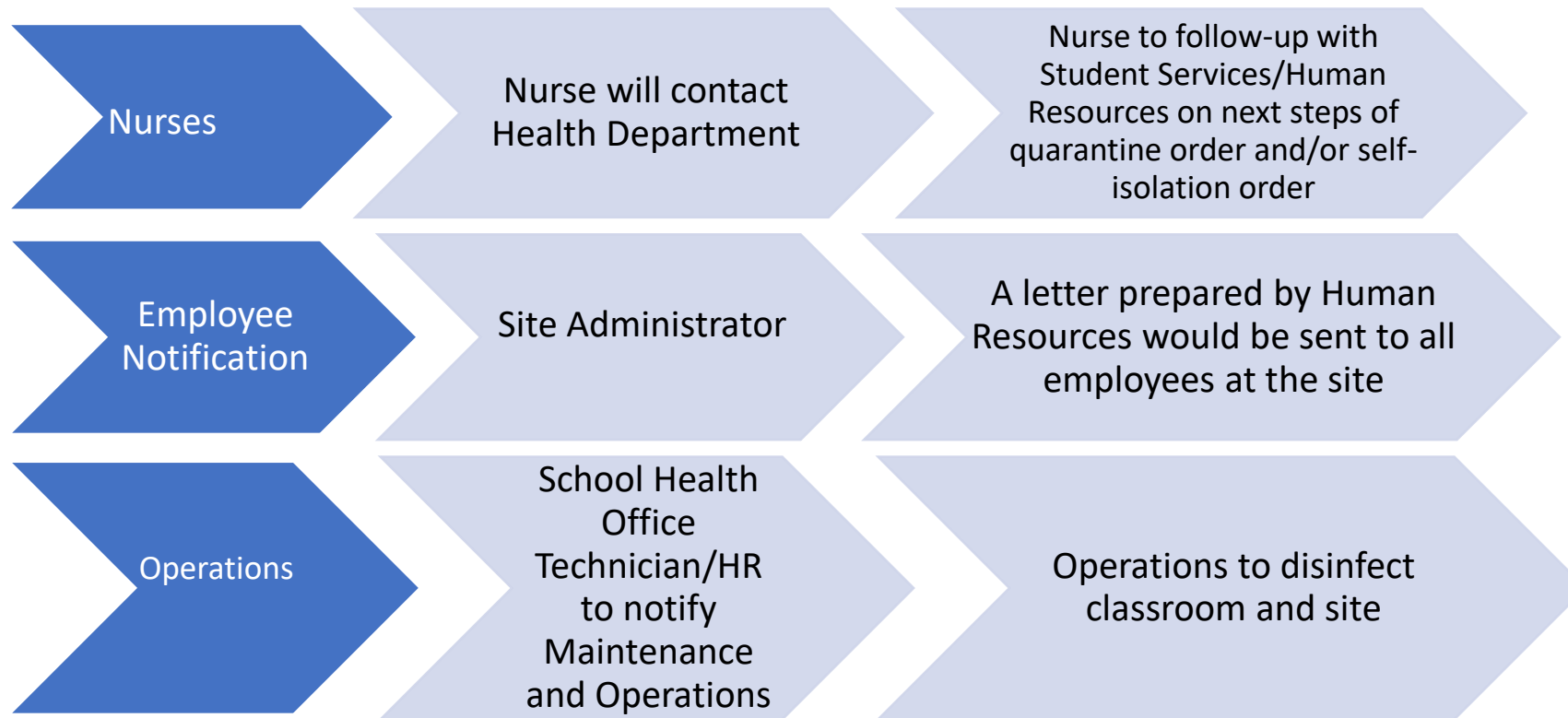

Based on DPH guidance as of May 11, 2021

Symptoms check room

- Symptoms check room established at each school site
- Unique signs for symptoms check rooms are already at sites
- HEPA room filters have been placed in all symptoms check rooms
- Each site's symptoms check room has PPE
 - N 95 masks
 - Shields
 - Hospital gowns

Based on DPH guidance as of May 11, 2021

Notifications

- AB 685 – Notifications will be sent to all staff and students on site
- Notification are delineated into two different notifications:
 1. With close contact (Within 6 feet for 15-minutes or more over a 24-hour period with a positive person.)
 2. Without close contact (You were on a site where a positive person had been at, but you were not near the infected person.)
- Law describes protection of the identity of COVID-19 positive person

Based on DPH guidance as of May 11, 2021

New Staff Safety Measures

- Restrooms are receiving new touchless sink fixtures
- Paper towel dispensers will be hands free
- Continue to limit access to common areas
- Meetings and gatherings will continue to take place electronically, when at all possible.

Based on DPH guidance as of May 11, 2021

Parent notification

Written notification will be provided to parents including:

- Mitigation strategies of masks, physical distancing and handwashing
- Drop off and pick up procedures and locations
- Directional movement in class and on campus
- Daily symptoms check done at home.
- Keep ill students at home
- Updating of any personal contact information
- Water filling stations
- Restroom procedures
- Grab and go breakfast and lunch procedures

Based on DPH guidance as of May 11, 2021



PARAMOUNT UNIFIED SCHOOL DISTRICT
PREPARING STUDENTS FOR COLLEGE AND CAREERS

Summer School Overview 2021



Summer School Dates

Session 1: June 14 –July 1

Session 2: July 6 –July 22

Odyssey STEM Academy: June 14-July 9



PARAMOUNT UNIFIED SCHOOL DISTRICT

PREPARING STUDENTS FOR COLLEGE AND CAREERS

Elementary Summer School Program

Elementary Program Overview

- For students entering grades 1-5
- 2 programs: Literacy & Mathematics AND Enrichment
- Monday-Thursday 8:30-11:45 a.m.
- Lincoln, Wirtz, Los Cerritos, Collins and Distance Learning
- 14:1 student to teacher ratio for in-person classes
- An individual set of materials will be distributed to all participating students
- Extended School Year for students with special needs (including SDC Pre-School)

Elementary Program Overview

Literacy/Mathematics	Enrichment
<p>Literacy</p> <ul style="list-style-type: none">• Foundational Reading Skills• Comprehension <p>Math</p> <ul style="list-style-type: none">• Numeracy (grades 1-3)• Fractions (grades 4-5)• Problem-solving	<p>Book Study (with authentic literature)</p> <p>Science Units on Water and Matter</p> <p>Visual and Performing Arts integration (embedded in instruction)</p>

Both options will include:

- support for social-emotional learning and English Learners
- virtual assemblies offered by Discovery Cube and the Music Center



PARAMOUNT UNIFIED SCHOOL DISTRICT

PREPARING STUDENTS FOR COLLEGE AND CAREERS

Middle School Summer School Program

Middle School Program Overview

- For students entering grades 6-8
- 3 daily classes: Student Success, Mathematics and Enrichment
- Monday-Thursday 9:00 a.m.-12:00 p.m.
- Alondra, Hollydale, Jackson, Park, Zamboni (located at Keppel), and Distance Learning
- 14:1 student to teacher ratio for in-person classes
- An individual set of materials will be distributed to all participating students
- Extended School Year for students with special needs

Middle School Program Overview

Student Success	Math	Enrichment
<p>Literacy skills applicable to all content areas using AVID strategies (e.g., close reading, notetaking, etc.)</p>	<p><i>Grade 6:</i> Review of Fraction Operations</p> <p><i>Grades 7-8:</i> Statistics (content not taught during the school year)</p>	<p>Varies by school site</p> <p>Examples of proposals include:</p> <ul style="list-style-type: none"> • Art history • Chinese • Yoga • Project Lead the Way: Design and Modeling • Music Theory and History

Support for social-emotional learning and English Learners will be integrated.

STAR Program





PARAMOUNT UNIFIED SCHOOL DISTRICT

PREPARING STUDENTS FOR COLLEGE AND CAREERS

High School Summer School Program



High School Summer Focus

Credit recovery, enrichment, specialized student support, transition to high school, and Extended School Year for special education students in accordance with their IEP's.

Locations:

- Buena Vista High School
- Odyssey STEM Academy
- Paramount Community Day School
- Paramount High School-West Campus
- Paramount High School-Senior Campus



High School Summer School At a Glance

- In-person instruction, synchronous instruction (virtual/distance learning) and online credit recovery (Edgenuity) for courses required for graduation
- Summer bridge for incoming 9th graders: ELA, Math & Social Emotional Learning
- Enrichment:
 - New CTE Prep-Entrepreneurship Enrichment Course: "Biz Camp"
 - AP Prep courses to build study skill levels in Fall AP courses
- Khan Academy recommendations by grade level/subject to support learning loss
- Counselor support for graduates with their transition to college
- Extended School Year for special education students in accordance with their IEP's
- AB288 Dual Enrollment (Compton College Cohorts #1, #2 & #3)



Summer School Registrations

Grade Span	In-person	Distance Learning	Total
Elementary	1087	409	1,496
Middle School	485	235	720
High School	764	718	1,482

Board of Education - District Direction and Next Steps

- **DISTRICT PLAN**: Continue the implementation process for Summer School and the planning process for Fall. Maintain contact with regulatory authorities and State guidelines to adapt district plans to latest protocols
- **VACCINATIONS**: Continue the vaccine process as indicated by the State and Local departments of public health
- **INFORMATION REVIEW**: Continue the review of legislation, CA DPH and LA DPH directives and the information provided by LACOE to provide the Board of Education the latest information

Questions?